

REPLACEMENT PARTS

ITEM	PT/ASSY	SPECIFY FINISH	DESCRIPTION
1	10960	YES	HEX ESCUTCHEON
2	2-143	YES	HANDLE ONLY, DIV.
3	2-173		CROSS HANDLE ASSEMBLY W/O BUTTON
4	92000		SCREW 8 - 32 X 1/8 SS
5	10192		HEX KEY TOOL, #8 5/64
6	1-109	YES	DIVERTER BUTTON W/ ADHESIVE
7	91754		O-RING, #2-034, EPDM, 50 DURO - GREY

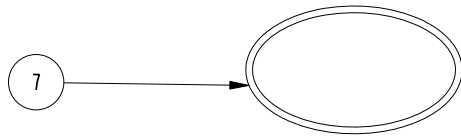
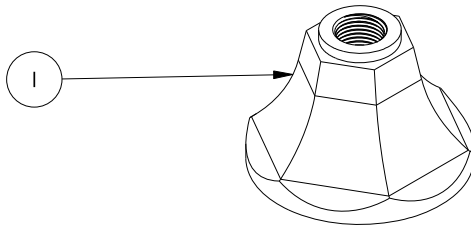
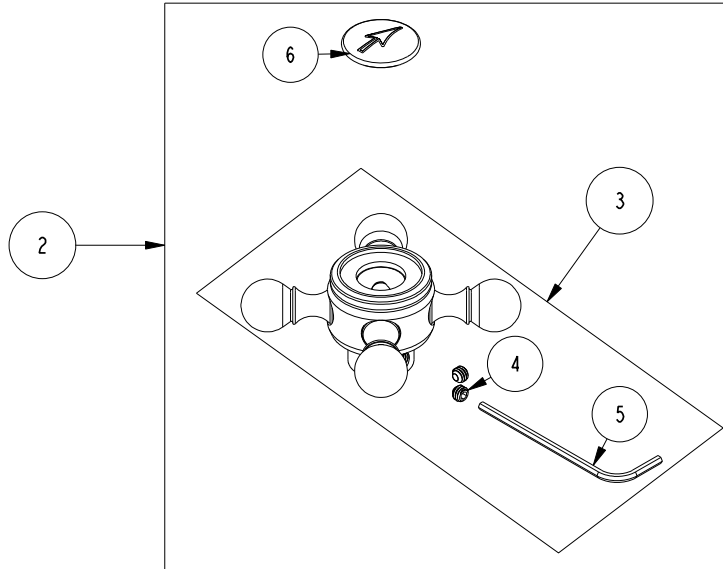

Cross handle Trim
3-595

REV C EN-4989 05/09/25

NEWPORT BRASS.

t: 949.417.5207 | www.newportbrass.com